

Adding the Rainbow Brain to an Existing DIY DMX Network

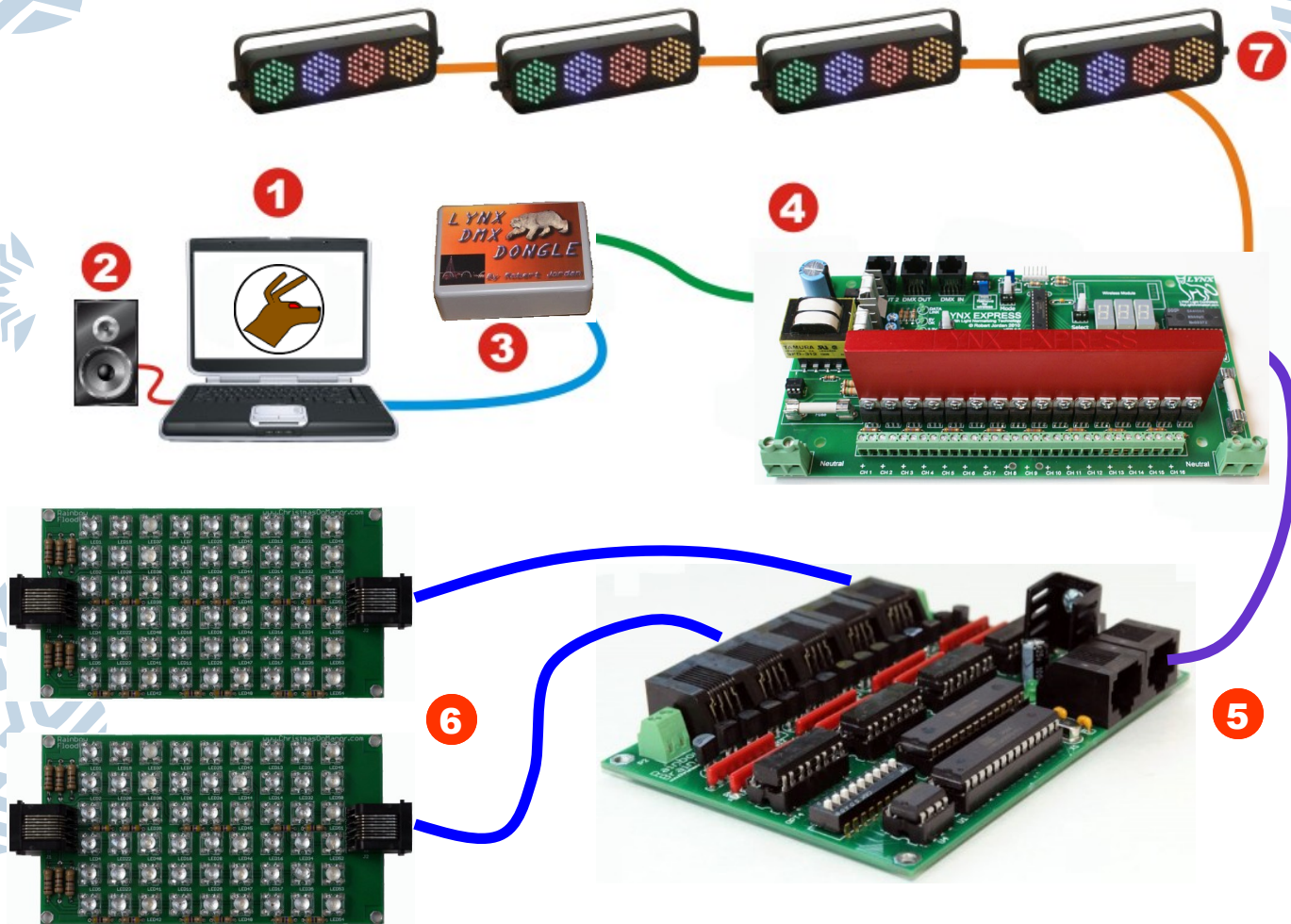

1. Vixen software running on a computer.
2. Speaker used for sound effects
3. Some sort of DMX dongle connected to computer (Lynx Dongle pictured)
4. DMX based DIY hardware connected inline (Lynx Express Pictured)
5. Out port of DMX hardware connects to Rainbow Brain via Cat-5 cable.
6. 5 output ports from the Rainbow Brain than connect to any of the Rainbow Lighting devices.
7. Standard Cat-5 cable connects from out port of DMX hardware (or Rainbow Brain) to an RJ45 to XLR adapter, than to standard DMX lighting devices.